

ONSITE+

Step Tip Arbor & Pilot Drill

THE LATEST **ONSITE TECHNOLOGY**

Unique
Patented
STEP TIP

PRECISE
holes
every time

Alpha
NO DOUBT

ONSITE+

Step Tip Arbor & Pilot Drill

Unique
Patented
STEP TIP

PRECISE
holes
every time

You may have heard of our game-changing Alpha Onsite+ Step Tip Drill Bit, which has revolutionised cutting and drilling practices in the trade industry.

Now, it's time to discover the difference our unique step tip design brings to your holesaw experience.

Meet the Alpha Onsite+ Step Tip Arbor and Pilot Drill – giving you a cleaner, faster, and more precise holesaw experience. Its unique design stays sharp, reduces wandering and skips the need for pilot holes, saving time and making every holesaw job easier.

PILOT DRILL RANGE:

Step Tip HSS Pilot Drill

- **Unique Patented Step Tip design** reduces heat & stays sharper longer
- **Fast accurate hole starting** without pre-drilling
- **Round accurate holes** without burring
- **Fully ground Premium M2 HSS** for extended life
- **Easier & safer to use** with no jamming or binding



Step Tip
HSS Pilot Drill
6.35 x 90mm

CODE: PLDST-1



Step Tip
HSS Pilot Drill
6.35 x 115mm

CODE: PLDST-2



ARBOR RANGE:

Small Holesaw Arbor
suits Bi-Metal Holesaws

14 - 30
mm

Drill Bit: 6.35 x 90mm
Step Tip
HSS Pilot Drill
Shank: 11/32" Quick
Change for 10mm
(3/8") Chuck

CODE: ARBST-1

11/32"
QUICK
CHANGE

for 10mm
(3/8") chuck



Large Holesaw Arbor
suits Bi-Metal Holesaws

32 - 250
mm

Drill Bit: 6.35 x 115mm
Step Tip HSS Pilot Drill
Shank: 7/16" Hex for
13mm (1/2") Chuck

CODE: ARBST-2

7/16"
HEX
for 13mm (1/2")
chuck



Large Holesaw Arbor
suits Bi-Metal Holesaws

32 - 250
mm

Drill Bit: 6.35 x 90mm
Step Tip
HSS Pilot Drill
Shank: 11/32" Quick
Change for 10mm
(3/8") Chuck

CODE: ARBST-3

11/32"
QUICK
CHANGE

for 10mm
(3/8") chuck



BEST PRACTICE GUIDELINES

The Alpha Onsite+ Step Tip Arbor & Pilot Drill is part of Alpha's Onsite+ range, designed specifically to perform with maximum efficiency so you can save time onsite and knock off early.

- Always apply lubricant before drilling into metal
- No need to pre-drill pilot hole, the unique patented step tip design will eliminate wandering and create precise, burr-free holes
- Apply recommended RPM and pressure
- Always use the appropriate lubricant when drilling to ensure product efficiency and longevity. Consistently applying lubricant will protect bit against heat and friction and provide excellent surface finish

Always wear Personal Protective Equipment (PPE) when using power tool accessories. Bits can become very hot with continuous usage.

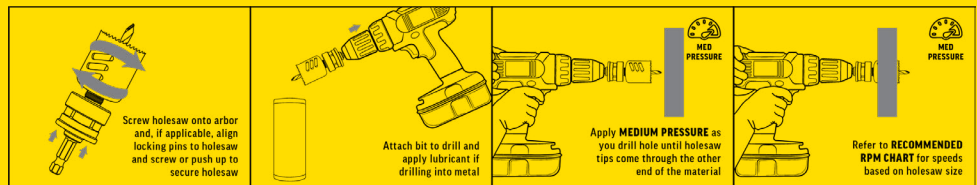

SCAN QR CODE
FOR RECOMMENDED
HOESAW RPM AND
BEST PRACTICE VIDEOS



©COPYRIGHT SHEFFIELD GROUP 2025. No part of this publication may be copied, scanned or reproduced in whole or part in any form without written permission from Sheffield Group. E&OE. 20250110